

NEX SERIES® SIMPLEX PANEL

Single Phase Simplex Control Panel

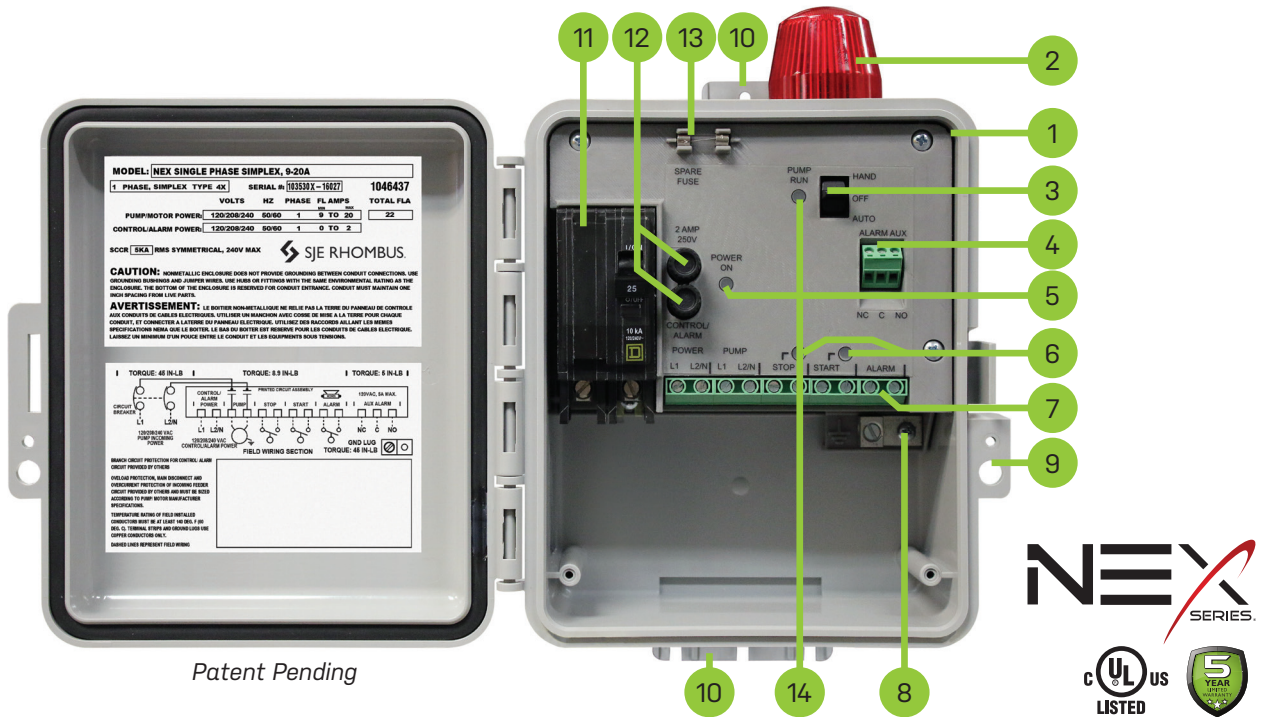

The **NEX Series**® simplex panel is designed to control one single phase pump in water and wastewater applications. Two control switches activate a power relay to turn the pump on and off. If an alarm condition occurs, an additional alarm switch activates the audible/visual alarm system. The **compact design** (8" x 6" x 4") is ideal for residential applications. Universal pump voltage and control/alarm power allow the NEX Series® panel to handle **three voltages** (120/208/240V). The **innovative internal design** of components and integral **mounting tabs** make **installation quick and simple**. Includes integral padlockable latch for added safety.

PART NO. DESCRIPTION

- **1046436** NEX, 120/208/240V, 0-12 Amps, Floats*
- **1046437** NEX, 120/208/240V, 9-20 Amps, Floats*
- **1047662** NEX, 120/208/240V, 0-12 Amps, No Floats
- **1047663** NEX, 120/208/240V, 9-20 Amps, No Floats

* Includes (3) 20' SJE SignalMaster® control switches

COMPONENTS

1. NEMA 4X outdoor rated enclosure
2. Red LED alarm beacon
3. HOA selector switch
4. Auxiliary alarm contacts
5. Green control/alarm power indicator
6. Red float status indicators (stop/start)
7. Field wiring terminal block
8. Ground lug
9. Integral padlockable latch
10. Integral mounting tabs
11. Pump circuit breaker
12. Control/alarm fuses
13. Spare fuse
14. Green pump run indicator

Not Shown: Alarm piezo horn and test/silencepush button

