

Model TMM-1070 Mechanical Mixing Valve with Thermostatic Limit Stop Eng. No. 87500

CAPACITIES – MODEL TMM-1070

Pressure Drop PSI	5	10	20	40
Valve Number	Capacity			
TMM-1070-GPM	.5	1	1.6	1.9
TMM-1070-LPM	1.8	3.7	6	7

The point of use mixing valve shall be a mechanical mixing valve with a high temperature limit stop with automatic reset. The mixing valve shall have compression fittings and a means to adjust outlet temperature. Valve construction will include a lead free brass body and integral back flow checks. The mixing valve shall be Lawler model TMM-1070.

Specifications

- Hot water supply temperature: 140°F max.
- Water supply pressure (static): 125 psi max.
- Flow rate @ 45 psi: 2.1 gal/minute min.
- Shut off temperature: 118°F +/-3°F.
- Min. operating pressure: 5 psi.
- Min. flow rate: .25 GPM.
- Integral rubber duck-bill back-flow checks.
- Pressure must be equal between supplies.

Benefits

- Automatically shuts down flow of water prior to temperature reaching 120°F. per ASSE 1070 limiting device standard.
- Offers choice of temperature settings from full cold through 115°F.
- Easy installation.
- Backed by Lawler's One Year Warranty.

FLOW CAPACITIES SINGLE STAGE - MODEL TMM-1070

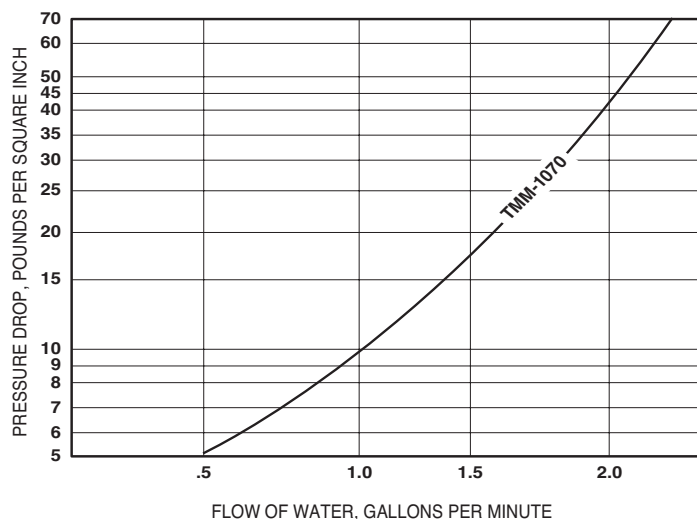

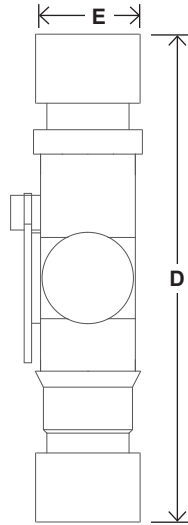
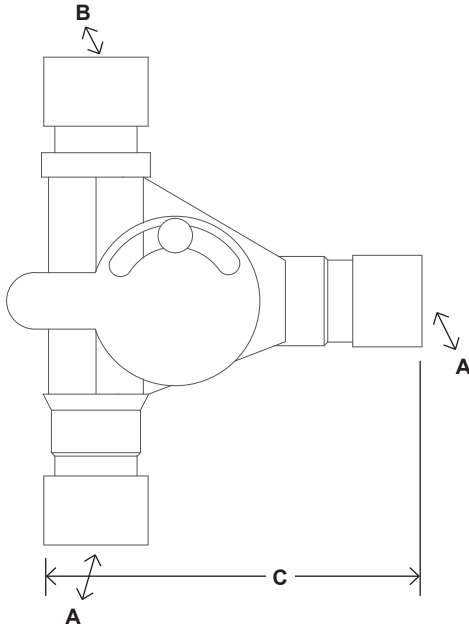

Model TMM-1070 Eng. No. 87500

Temperature Adjustment

The temperature adjusting dial is located on the cold inlet. Turning the dial clockwise will lower the outlet temperature, turning the dial counter-clockwise will raise it. The valve can not be adjusted above its shut-off temperature of 120°F.

Fitting the Valve

Connect the cold supply to the inlet marked "C".
Connect the hot supply to the inlet marked "H".
Connect the outlet pipe to the end marked with an arrow.

Connections can be standard 3/8" compression fittings (fittings supplied) or with 3/8" flexible hose connections.

If flexible hose is used then the supplied spacers must be used to ensure the non-return valves are retained.

The non-return valves are held in place by the end of the pipe when compression fittings are used.

DIMENSIONS

Valve Number	A	B	C	D	E
TMM-1070	3/8"	3/8"	2-1/2"	3-1/2"	7/8"

Dimensions are for reference purposes only. For rough-in dimensions please refer to Lawler's Revit/BIM models found at temperedwater.com.

Inlets & outlet are 3/8" compression fittings. Checks included within inlets.